

# Gate Valves

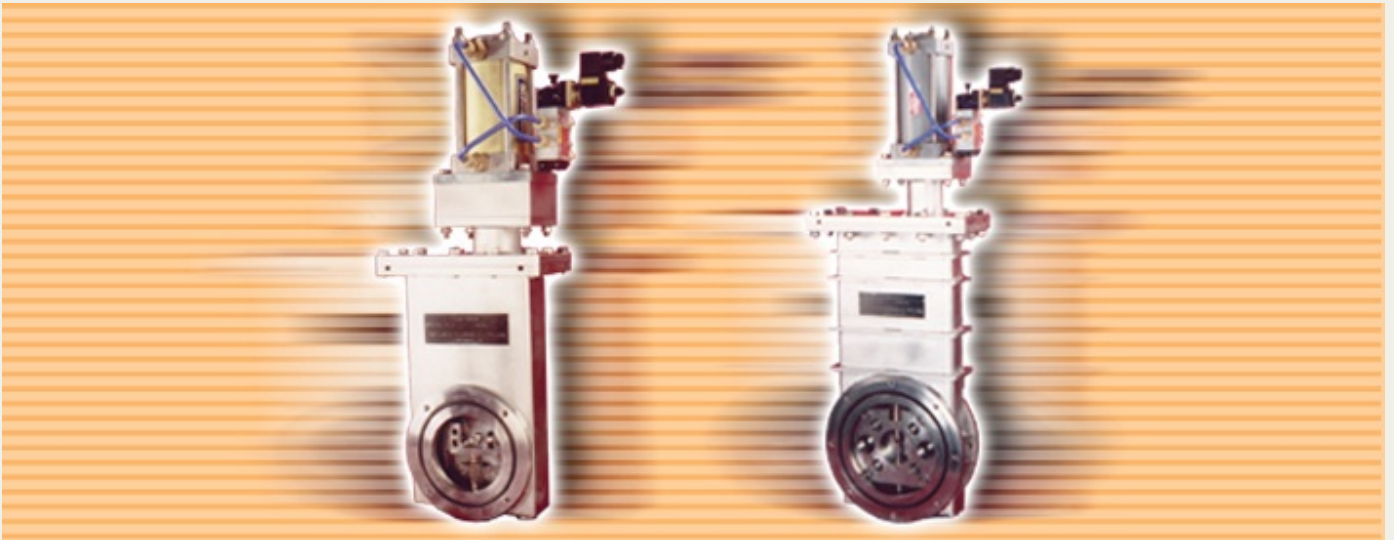

These high conductance, stainless steel SS 304 fabricated valves are designed for reliability and for use as "in-line" chamber isolation valves and load lock applications. These valves are fitted with Neoprene "O" rings as standard and optionally viton "O" rings are offered. Viton sealed valves can be baked up to 150°C under normal mode. These valves undergo stringent leak detection tests on a Helium Mass Spectrometer for leak tightness up to  $10^{-10}$  std cc/second. These valves are offered in several models and can be operated in both electropneumatic as well as manual modes.

Gate Valves are used immediately above the mouth of a diffusion pump or above the water-cooled baffles. The closure between the two sides is made by the movement of a horizontal plate in its own plane, the seal being an elastomer. These valves are made in sizes of 1", 2", 4", 6", 8", 10", 20" sizes as a standard product.

### Salient features:

- 1" diameter opening to 20" diameter
- Stainless steel fabricated
- High conductance
- Helium leak tested
- Short stroke

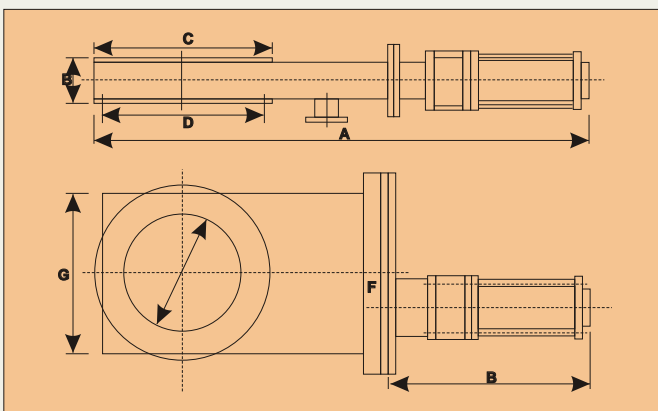

| Manual Gate Valve Dimensions |      |     |     |     |       |     |       |
|------------------------------|------|-----|-----|-----|-------|-----|-------|
| Sizes                        | A    | B   | C   | D   | E     | F   | G     |
| 4"                           | 720  | 389 | 178 | 159 | 69.5  | 230 | 168.5 |
| 10"                          | 1057 | 415 | 335 | 250 | 102.5 | 335 | 420   |

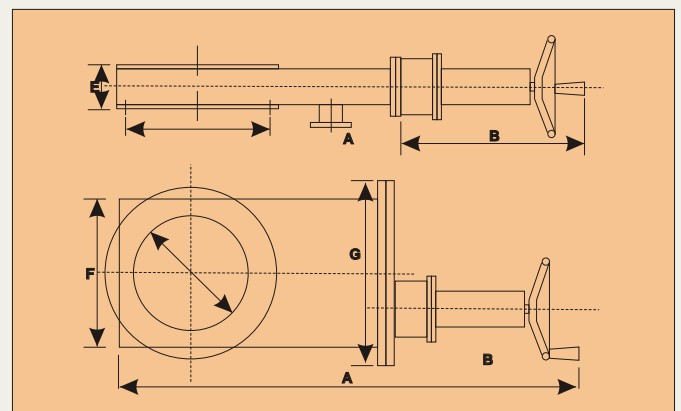

| Pneumatic Gate Valve Dimensions |     |     |     |     |       |     |       |
|---------------------------------|-----|-----|-----|-----|-------|-----|-------|
| Sizes                           | A   | B   | C   | D   | E     | F   | G     |
| 4"                              | 570 | 239 | 178 | 159 | 69.5  | 230 | 168.5 |
| 10"                             | 983 | 335 | 250 | 335 | 102.5 | 335 | 420   |

HIND HIGH VACUUM CO. PVT. LTD.

Site No.17, Phase 1, Peenya Industrial Area, Bangalore - 560 058, India. Ph: 080-8394518, 8394615, 8394617, 8394640. Fax: 080-8394874. E.Mail : info@hindhivac.com

SALES OFFICE

Baroda: Ph: 33178, 359039. Fax: 0265-331505. Calcutta: Ph: 4661462, 4649182. Fax: 033-4662830. Chennai: Ph: 4891061. Fax: 044-4891061. Hyderabad: Ph: 3235504, 3234609. Fax: 040-3235504. Mumbai: Ph: 5550003, 5587219. Fax: 022-5563724. New Delhi: Ph: 6282410, 6282411. Fax: 011-6282412. Pune: Ph: 5466095, 5442426. Fax: 020-5466095.